

S SERIE S Mouvex Technology

Eccentric disc pump

Sealing

- Designed without mechanical seals, packing or magnetic drive, the S-Series pumps eliminate leakage.
- The transmission mechanism is protected by a tasteless, high-resistance elastomer sleeve meeting FDA requirements.

Cleaning

- The S-series pumps are designed for cleaning in place (CIP and SIP).
- The S-series pumps can also be cleaned by hand thanks to their quick and easy opening.
- 3A certified pump.



Overall dimensions

- Due to its small size and low weight, the S-series pumps are ideal for "baseframe" mountings.

ATEX certified.

 II 2 G IIB T2, T3, T4, T5 (according to pumped product temperature)

Can run dry in ATEX environment.

**Up to 12 m³ per hour
6 bars and 10 bars pressure**



S2



S4C



S6C

S SERIE S - Mouvex Technology - Eccentric disc pump

◆ Low pulsation rate

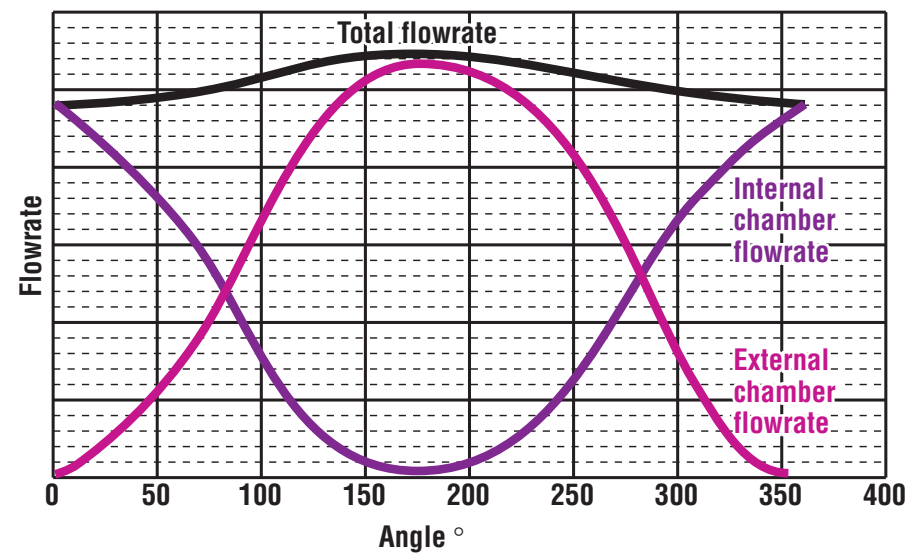

● Mouvex Technology

Disc against the cylinder (front view)

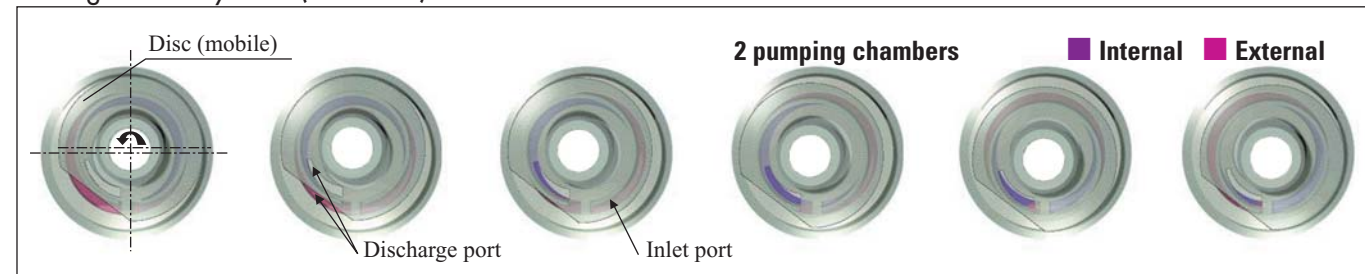

Disc against the cylinder (cross section)



● Low shearing

Displacement of the disc in the cylinder

- The disc has an eccentric motion (driven by an eccentric shaft).
- Each point of the disc has the same linear speed.
- We get a circular translation.
- The mouvex technology allows a flowrate with low linear speed.

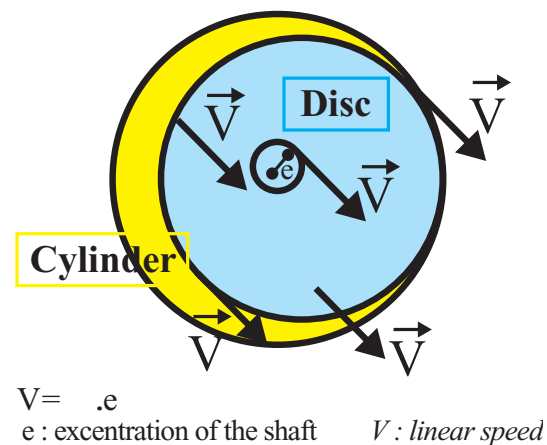

● Main advantages

- Self-priming with strong suction power
- Ability of draining the pipes (Inlet and Outlet)
- Ability of dry running
- Low shearing
- Maintains delivery/pressure performances over time
- Outstanding volumetric efficiency
- Pumped product constantly renewed
- Ability to pump high and low viscosity products
- Output not affected by variation in viscosity
- Low linear speed

S-SERIES PUMP (cross section)

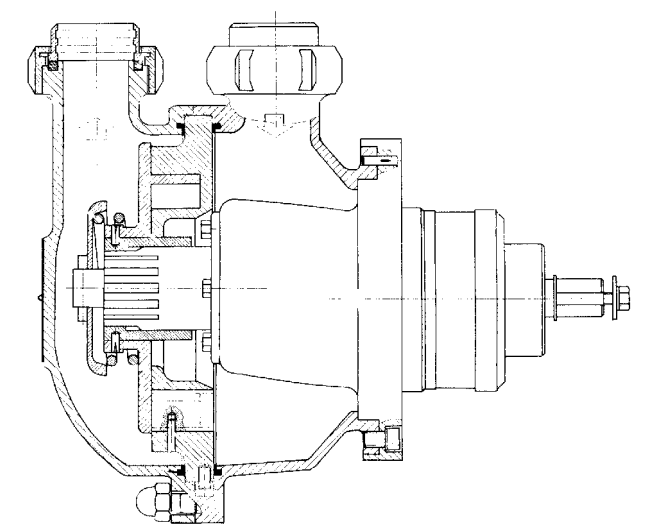

● Pump without mechanical seal or packing (seal free design)

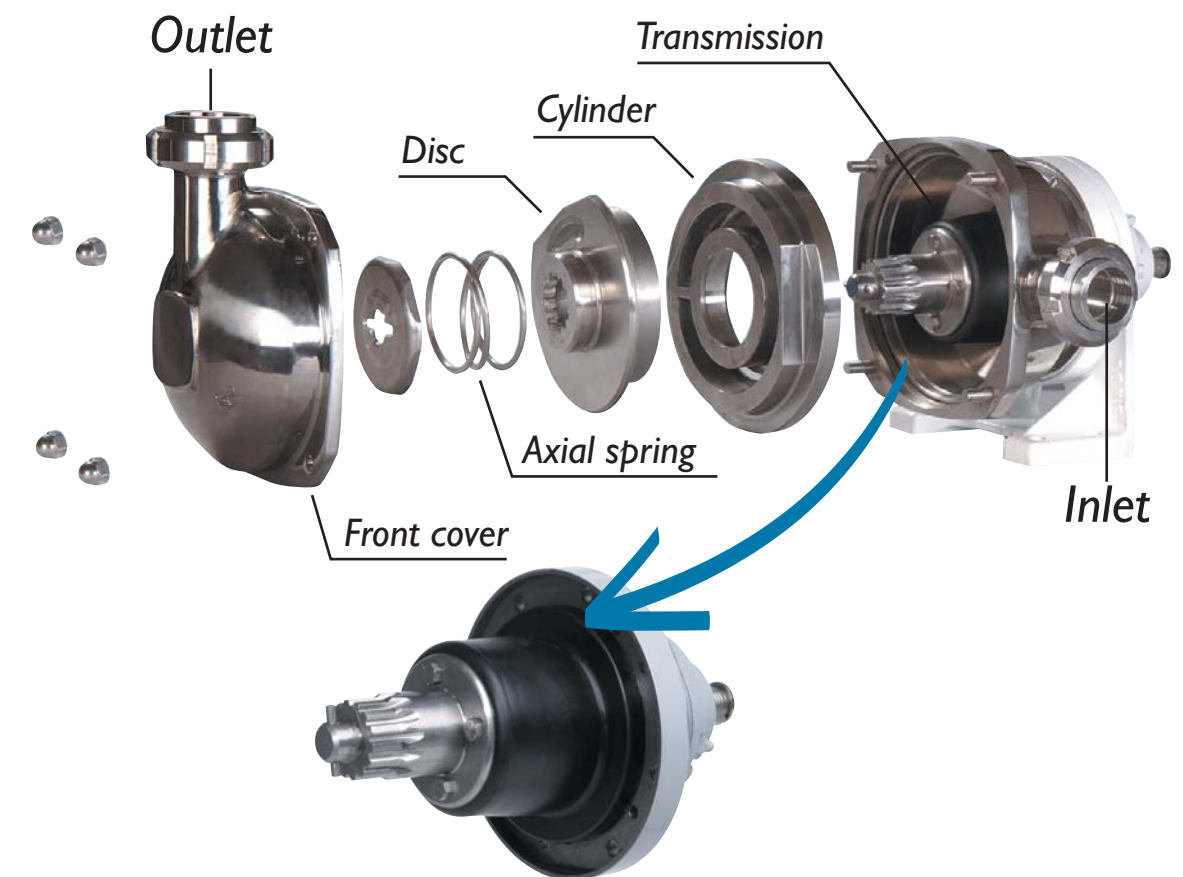

As per CE Directive (67/548/EEC), the composition of the transmission elastomers does not contain DEHP and/or DBP.

S SERIE S - Mouvex Technology - Eccentric disc pump

● Pharmaceuticals, cosmetics

Pumped product unaffected

Shear-sensitive products are safe when pumped with the S-Series pumps thanks to :

- permanent product renewal in the pump body
- the slow movement speed of the disc

Performances

- Very accurate volume metering enabling precise dosing and mixing for viscous or fluid products
- High-speed priming and self-priming
- Capability to run dry
- Capability to clear the pipes (inlet and outlet)



Ointment, syrup, shampoo, lotion, toothpaste, etc.



● Food industry

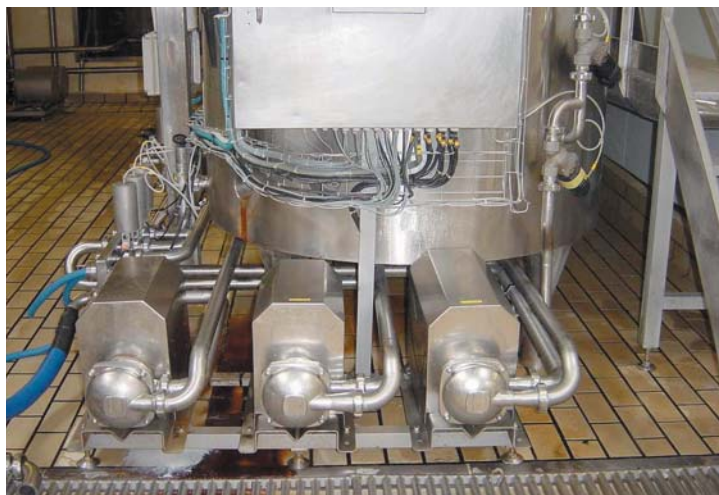

Sauce, yogurt, cream, yeast, flavouring, applesauce, liquid egg, liquid sugar, wine, etc.



● Performances

S-Series pumps flowrates

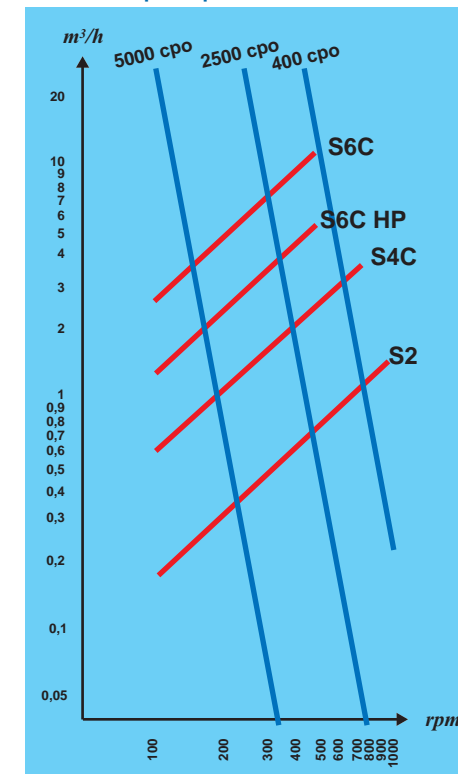

Dynamic viscosity measured by rheomat



Cleaning in place

During the "cleaning in place" (CIP) phase, the S-Series pump must be running at low speed (variable speed pump) or be shut down (fixed speed pump) or possibly be running in discontinuous cycles.

The centrifugal pump delivering the cleaning solution must be installed in-line (CIP pump delivery supplying the S pump intake)

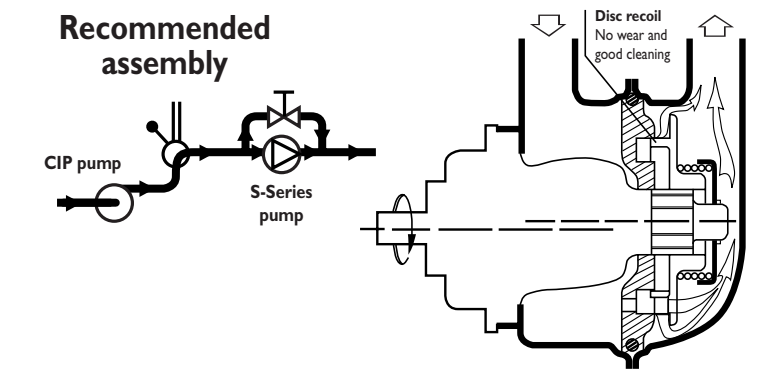

S-Series pump using recommendation during CIP ("cleaning in place")

| | S2 | S4C | S6C | |
|--|----|-----|-------|----|
| CIP flowrate (m³/h) (delivered by centrifugal) | 10 | 10 | 20/25 | |
| Use of external by-pass | | | | |
| CIP flowrate (m³/h) | 15 | YES | NO | NO |
| | 20 | YES | NO | NO |
| | 25 | YES | YES | NO |
| | 30 | YES | YES | NO |
| | 35 | YES | YES | NO |
| | 40 | YES | YES | NO |

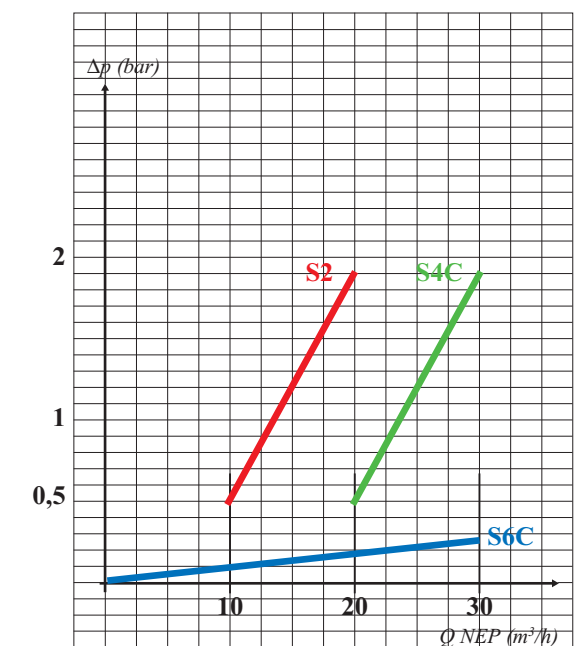

S SERIE S - Mouvex Technology - Eccentric disc pump

● Illustrations



S2 on hot suppository



S2 on ointment



S6C on whey



S2 on liquid sugar



S4C on flavoured milk



S4C and S6C on cosmetic cream



S6C on liquid egg



S4C on toothpaste



S4C on coffee liquor



S4C on yogurt

S SERIE S - Mouvex Technology - Eccentric disc pump

◆ Features :

| S-Series Pumps | S2 | S4C | S6C | S2 HP | S6C HP |
|--|------------------|------------------|------------------|------------------|------------------|
| Max. flowrate (liters/hour) | 1500 | 4000 | 12000 | 1100 | 6000 |
| Max speed (rpm) | 900 | 750 | 500 | 900 | 500 |
| Max. output pressure (bar) | 6 | 6 | 6 | 10 | 10 |
| Max. operating temperature* VITON EPDM | 120° C 100° C | 120° C 100° C | 120° C 100° C | 120° C 100° C | 120° C 100° C |
| Interior diameter of ports (mm) | 22 | 35 | 60 | 22 | 60 |
| 3-part couplings for tube with external dia. (mm) | 38 | 51 | 63 | 38 | 63 |
| Max. dimension A (mm) | 340 | 340 | 460 | 340 | 460 |
| Max. dimension B (mm) | 880 | 925 | 1240 | 880 | 1240 |
| Max. dimension C (mm) | 505 | 525 | 670 | 505 | 670 |

*SIP 120° C (20 minutes) - Please contact us for any other specific characteristics.

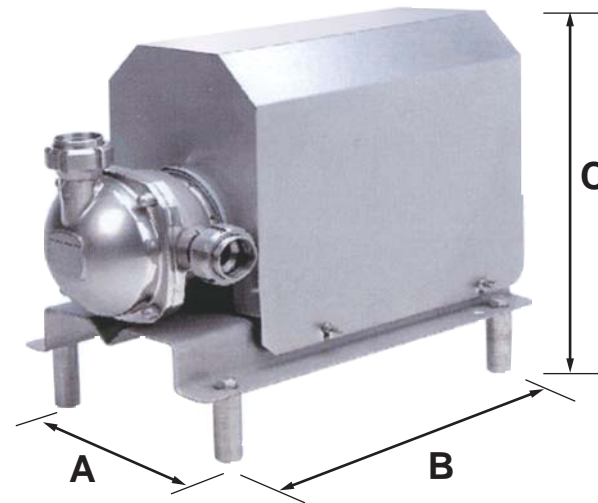

Options

- Choice of couplings
- Mobile unit
- Shroud

MOUVEX
BLACKMER
A DOVER COMPANY

Mouvex reserves the right to modify the information and illustrations contained in this document without prior notice. This is a non-contractual document. 01/09
Printed in FRANCE by Filigrane
© 2009 Mouvex

ZI la Plaine des Isles
rue des Caillottes
89000 AUXERRE - FRANCE
T + 33.3.86.49.86.30
F + 33.3.86.46.42.10
contact@mouvex.com

www.mouvex.com

MOUVEX
MEMBER OF
PSG
PUMP SOLUTIONS GROUP
A DOVER COMPANY

Distributed by :